

Advanced  
Engineering

Hitachi Tool

**HITACHI**  
Inspire the Next

# Milling Chucks AMC

for **Indexable  
Milling**  
Modular Series

No. 705.2

## Modular Chucks

Run-out  $3\mu$

### ▽ Roughing



### ▽▽▽ Finishing



HSK 63



SK 40



### Using Length

HSK 63 25 ~ 100 mm

SK 40 10 ~ 90 mm

Milling Chucks

HSK 63 MD | DIN 69893 HSK

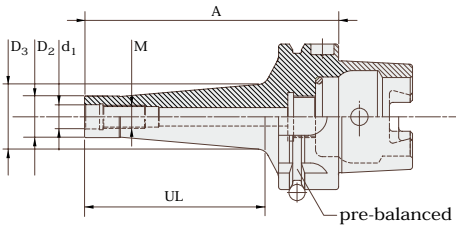

d <sub>1</sub>	+0
	+0.005

ID Code	Item Code	M	A	UL	d <sub>1</sub>	D <sub>2</sub>	D <sub>3</sub>
NT 168	HKA063MD008025	8	60	25	8.5	13	15
NT 184	HKA063MD008050	8	85	50	8.5	13	19
NT 169	HKA063MD008075	8	110	75	8.5	13	22
NT 185	HKA063MD008100	8	135	100	8.5	13	24
NT 170	HKA063MD010025	10	60	25	10.5	18	23
NT 186	HKA063MD010050	10	85	50	10.5	18	25
NT 171	HKA063MD010075	10	110	75	10.5	18	28
NT 187	HKA063MD010100	10	135	100	10.5	18	30
NT 188	HKA063MD012025	12	60	25	12.5	21	24
NT 172	HKA063MD012050	12	85	50	12.5	21	30
NT 189	HKA063MD012075	12	110	75	12.5	21	32
NT 173	HKA063MD012100	12	135	100	12.5	21	35
NT 190	HKA063MD016025	16	60	25	17	29	29
NT 174	HKA063MD016050	16	85	50	17	29	34
NT 191	HKA063MD016075	16	110	75	17	29	37
NT 175	HKA063MD016100	16	135	100	17	29	41

### Milling Chucks

#### SK 40 MD | DIN 69871

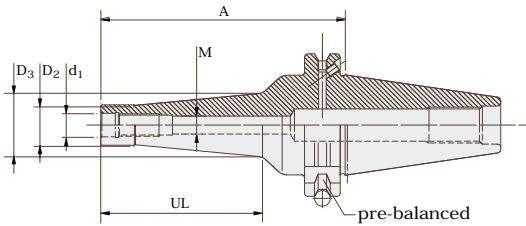

d <sub>1</sub>	+0
	+0.005

ID Code	Item Code	M	A	UL	d <sub>1</sub>	D <sub>2</sub>	D <sub>3</sub>
NT 192	SKB040MD008010	8	50	10	8.5	13	13
NT 176	SKB040MD008030	8	70	30	8.5	13	15
NT 193	SKB040MD008050	8	90	50	8.5	13	20
NT 177	SKB040MD008070	8	110	70	8.5	13	22
NT 194	SKB040MD010010	10	50	10	10.5	18	18
NT 178	SKB040MD010030	10	70	30	10.5	18	20
NT 195	SKB040MD010050	10	90	50	10.5	18	25
NT 179	SKB040MD010070	10	110	70	10.5	18	28
NT 196	SKB040MD012010	12	50	10	12.5	21	21
NT 197	SKB040MD012030	12	70	30	12.5	21	24
NT 180	SKB040MD012050	12	90	50	12.5	21	28
NT 198	SKB040MD012070	12	110	70	12.5	21	31
NT 181	SKB040MD012090	12	130	90	12.5	21	33
NT 199	SKB040MD016010	16	50	10	17	29	29
NT 200	SKB040MD016030	16	70	30	17	29	29
NT 182	SKB040MD016050	16	90	50	17	29	34
NT 201	SKB040MD016070	16	110	70	17	29	37
NT 183	SKB040MD016090	16	130	90	17	29	40

### Indexable Milling Modular Series

ASRM	AHUM	BCFM	ABPFM/ARPFM
<p><b>ASR Turbo – Maximum Volume &amp; High Feed Cutting (HFC)</b></p> <p>Ø 16 – Ø 40 mm</p>	<p><b>High-Feed Ultra – High Feed Cutting (HFC)</b></p> <p>Ø 16 – Ø 32 mm</p>	<p><b>Ball</b></p> <p>Ø 20 – Ø 32 mm</p>	<p><b>Ball / Radius – High Precision Finish</b></p> <p>Ø 10 – Ø 32 mm</p>
Ø10 M6	Ø12 M6	Ø16 M8	Ø20 M10
Ø25 M12	Ø32 M16	Ø40 M16	

**Product Range**

Solid Carbide End Mills

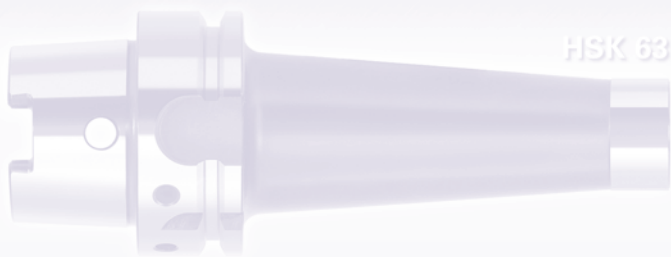

microEndMill  
**Epoch21**  
MINIATURE

▽ Roughing  
ASRM **3D-Cut**  
AHUM **CARBIDE**

Indexable Milling Tools



**Indexable Milling**

BCFM

ESM Speed End Mills  
EMC Power Drills

**ESM SPEED**

Milling Chucks

▽▽▽ Finishing  
ABPFM **Milling Chucks**  
ARPFM

Using Length

HSK 63	25 ~ 100 mm
SK 40	10 ~ 90 mm

**Distributed by:**



**Hitachi Tool Engineering Europe GmbH**

Itterpark 12 · 40724 Hilden · Germany · Phone +49 (0) 21 03 – 24 82-0 · Fax +49 (0) 21 03 – 24 82-30  
e-Mail info@hitachitool-eu.com · Internet www.hitachitool-eu.com  
© 2008 by Hitachi Tool Engineering Europe GmbH · 3rd Edition · Printed in Germany